



# AirTouch Solar Panel Charger

For Outdoor Camera

User Guide

Making the  
pleasure of  
home comfort  
an easy  
experience



**Thank you for trusting  
AirTouch Secure.**

**Need further help?  
Need the App or want to  
share your experience?  
Visit the link or scan the  
QR code below:**



[www.airtouch.net.au/  
welcome-secure](http://www.airtouch.net.au/welcome-secure)

---

## CONTENTS

What's Included .....	4
Introduction .....	5
Installation Instructions .....	6
Specifications .....	9
Contact Us.....	10
Warranty .....	11

## WHAT'S INCLUDED

Please consult this checklist for all parts.

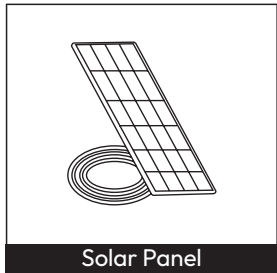

Solar Panel

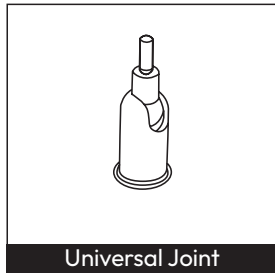

Universal Joint

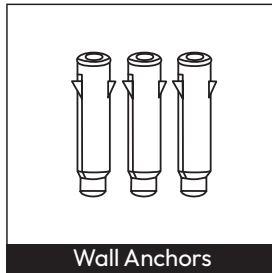

Wall Anchors

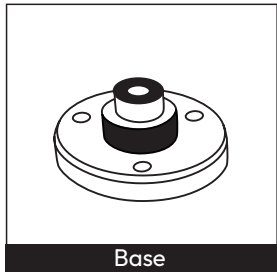

Base

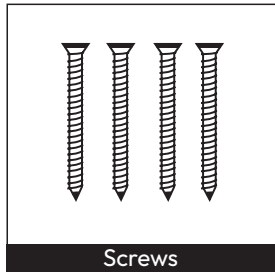

Screws



Locking Screw Cap

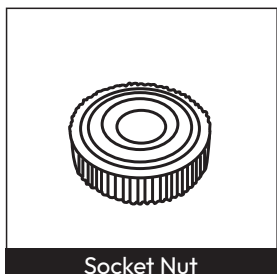

Socket Nut

## INTRODUCTION



### IMPORTANT SAFETY INFORMATION

Keep out of reach of children during installation. Do not modify the solar charger or camera. This may void the warranty or cause malfunction. Stop installation immediately if you feel unsafe, dizzy, or unwell.

- Always use a stable and properly rated ladder for outdoor use and place the on firm, level ground. Never overreach while on the ladder—reposition the ladder instead.
- Wear Safety Equipment. Consider a safety harness if working at heights above 6 feet.
- Avoid Electrical Hazards. If unsure, consult a licensed electrician.
- Work in Safe Conditions. Do not install during rain, lightning, or high winds.
- Secure All Components.
- Only use recommended tools for installation. Avoid makeshift solutions that could lead to injury or damage.

Visit [help.airtouch.net.au](http://help.airtouch.net.au) for more product information.

### LIABILITY AND DISCLAIMER

All specifications and procedures are correct at time of publication, but are subject to change without notice. Please read the instructions before installing. Polyaire Pty Ltd does not accept any responsibility for loss or damage that may occur as a result of the incorrect installation or operation of this AirTouch Secure product.

Welcome to your AirTouch Solar Panel Charger for AirTouch Outdoor Cameras. This product is designed to provide a continuous and eco-friendly power supply to your AirTouch Outdoor Camera, eliminating the need to remove camera from operation to charge the battery and the complexity of hardwiring.

Built with high-efficiency solar cells and durable, weather-resistant materials, this panel is optimised for year-round outdoor use. Enjoy the convenience of reliable, renewable power—day after day.

### COMPLIANCE

- RCM 
- Cyber Security Act 2024 & ETSI EN 303 645
- Australian Consumer Law & safety standards
- Origin: China
- Distributed in Australia by Polyaire Pty Ltd.

## INSTALLATION INSTRUCTIONS

1. Place Solar Panel in an area with consistent sunlight throughout the year. It only needs a few hours of direct sunlight each day to keep your camera powered. The amount of energy that the solar panel produces is affected by weather conditions, seasonal changes, geographic location, etc.
2. Fix the base to your mounting location using the included screws.  
Use a  $\Phi 6.0$  drill bit to drill a hole in the wall, then insert the anchor nail into the hole, and fix the base with screws.

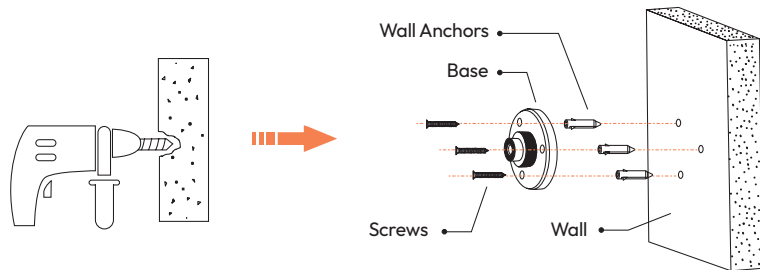

### CAUTION

Screw depth must not exceed 30mm. Overdrilling may cause structural or internal damage.

3. First, install the locking screw cap into the universal joint and then screw the circular socket nut into the universal joint.

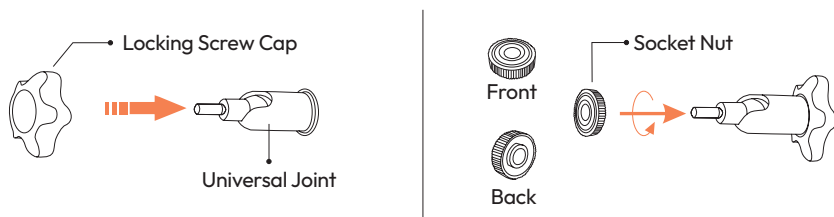

4. Screw the universal joint into the back of the solar panel. Tighten it firmly with the attached nut.

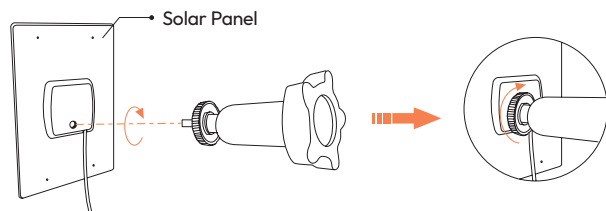

5. Screw the locking screw cap into the base. Make sure that the universal joint is angled upward.

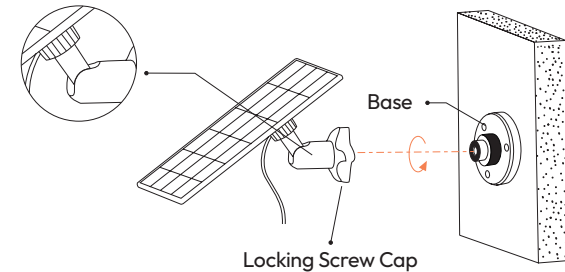

6. When adjusting the solar panel left or right, loosen the locking screw cap, turn the sleeve rod, and tighten the locking screw cap when the panel is in position.

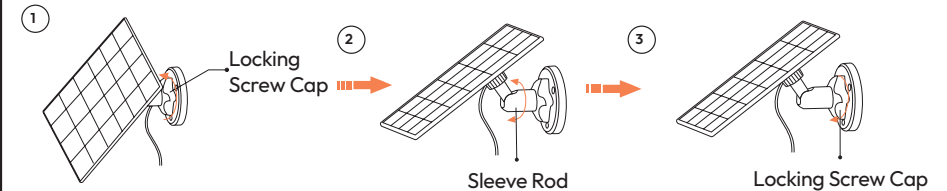

### HOW TO POSITION YOUR SOLAR PANEL

1. Find the area that gets the most direct sunlight throughout the day
2. Angle the solar panel upward 30°.
3. Point it south if in the northern hemisphere and north if in the southern hemisphere.

### IMPORTANT

1. Wipe the face of the solar panel with a soft, damp cloth regularly to clear any dust or debris.
2. Be sure to update the firmware version of the camera to the latest version.
7. Solar panel's angle can be adjusted up and down up to 90°.

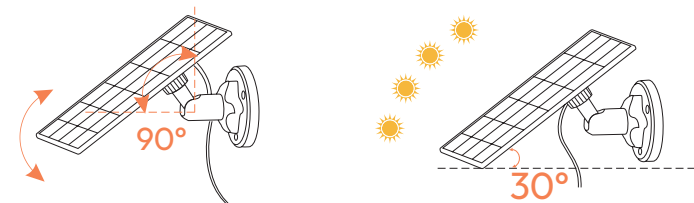

**TIP:** After the installation is complete, please check that all locking mechanisms are tightly secured.

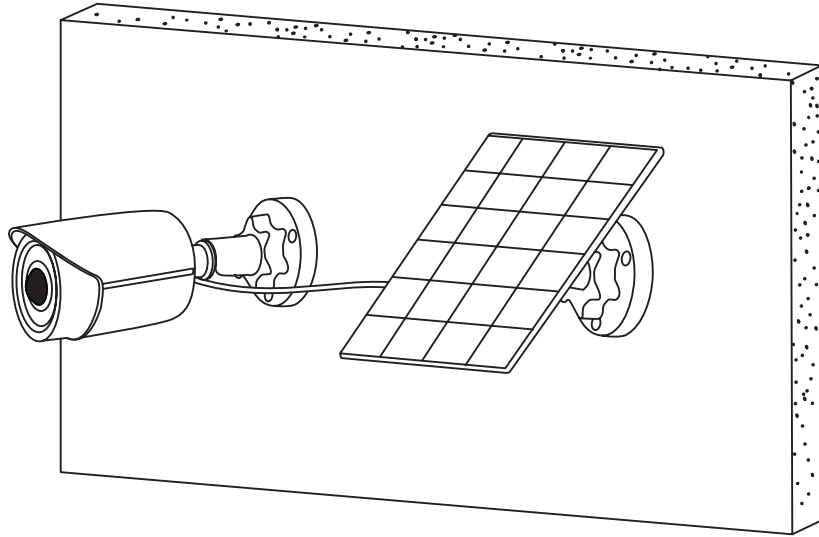

The solar panel for the outdoor camera is installed and powering the device efficiently.

## SPECIFICATIONS

### Basic Parameters

- Operating voltage:  
5V DC
- Operating temperature:  
-20.5°C to 48.5°C (-5°F to 120°F)
- Cable length:  
3m

### FCC Warning

Any changes or modifications not expressly approved by the party responsible for compliance could void the user's authority to operate the equipment. This device complies with part 15 of the FCC Rules.

Operation is subject to the following two conditions:

- 1: This device may not cause harmful interference.
- 2: This device must accept any interference received, including interference that may cause undesired operation.

### ISED RSS Warning

This device complies with ISED licence-exempt RSS standard(s). Operation is subject to the following two conditions:

- (1) This device may not cause interference, and (2) this device must accept any interference, including interference that may cause undesired operation of the device.

# Have any questions or need assistance?

Visit our Support Centre at [help.airtouch.net.au](http://help.airtouch.net.au) to find the answers you're looking for — or get in touch with **Team AirMate** for all your AirTouch support.

Scan the QR code to visit our help page

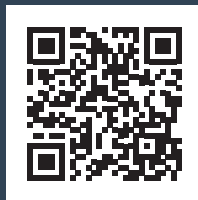

## WARRANTY

Thank you for purchasing this AirTouch product. In order to protect your rights, please read the following content carefully: The warranty period of our company's products is one year from the date of purchase or longer if local laws impose a longer minimum term, in which case the minimum term is the warranty period. During the warranty period, any faults caused by the product itself or for quality problems that arise under normal usage, AirTouch will provide a free replacement.

- Read all instructions before use. Failure to comply may result in injury or void warranty.
- To read our T&Cs, visit [www.airtouch.net.au/airtouch-terms-conditions](http://www.airtouch.net.au/airtouch-terms-conditions)



Polyaire Pty Ltd.  
Naylor House, Level 3 North  
191 Pulteney Street, Adelaide,  
South Australia, 5000  
(08) 8349 8466

[polyaire.com.au](http://polyaire.com.au)  
[airtouch.net.au](http://airtouch.net.au)

